



## Technical Service BULLETIN

August 26, 2004

Title:

### U240E/U241E TRANSAXLE SOLENOID IDENTIFICATION

Models:

Applicable Camry, Celica, Highlander, Matrix,  
RAV4 & Solara

TC005-04

TRANSMISSION & CLUTCH

**Introduction** This service bulletin provides information on the proper identification of the 5 solenoids used in the U240E/U241E automatic transaxles.

#### Applicable Vehicles

- 2002 - 2004 model year **Camry** and **Solara** equipped with **2AZ-FE** engines.
- 2000 - 2004 model year **Celica** equipped with **2ZZ-FE** engines.
- 2001 - 2004 model year **Highlander** equipped with **1AZ-FE** and **2AZ-FE** engines.
- 2003 - 2004 model year **Matrix** equipped with **2ZZ-FE** engines.
- 2001 - 2004 model year **RAV4** equipped with **2AZ-FE** engines.

#### Warranty Information

OP CODE	DESCRIPTION	TIME	OFF	T1	T2
N/A	Not Applicable to Warranty	—	—	—	—

#### Transaxle Solenoid Identification

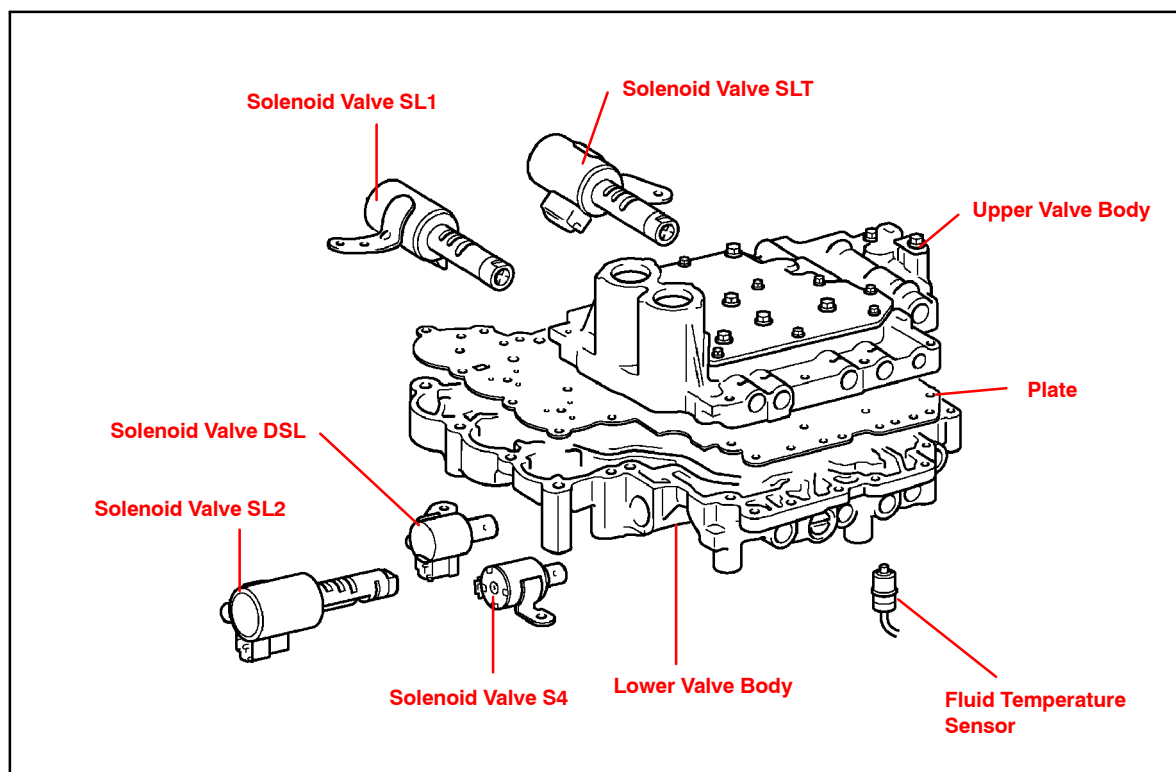

Toyota Supports ASE Certification

**Transaxle  
Solenoid  
Identification**  
(Continued)

Provided below is a chart listing the repair manual name as well as the parts catalog name and description of the solenoids used in the U240E/U241E automatic transaxles.

REPAIR MANUAL SOLENOID NAME	PARTS CATALOG DESCRIPTION
DSL	Solenoid Assembly, Automatic Transmission 3-way
S4	Solenoid Assembly, Automatic Transmission 3-way, #2
SL1	Solenoid Assembly, Clutch Control, #1
SL2	Solenoid Assembly, Clutch Control, #2
SLT	Solenoid Assembly, Line Pressure Control

**NOTE:**

Part numbers have not been included due to possible future part number changes.  
Refer to the parts catalog for proper current part number.